

## S Series - Surface Mount Panel Meters

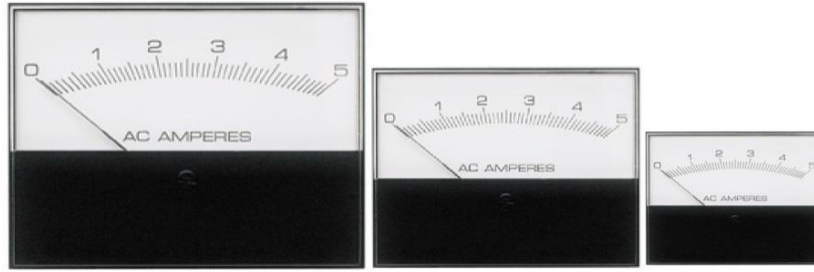

The S Series Surface Mount Panel Meters are clean-cut meters with straightforward design and pleasing aspect ratio are leaders of the Modutec line and add distinction to any instrument or control panel. Available in five sizes and a wide variety of types and ranges, they resolve many problems for the equipment designer and are always a solid choice for function and appearance.

AC Meters in this series are available in both moving coil (rectifier type) and iron vane versions. The latter has the virtue of being relatively insensitive to input distortion, while the rectifier type is less affected by frequency variations.

### Features:

- Available with DC, AC Iron Vane, and AC Rectified inputs
- DC:  $\mu\text{A}$ , mA, A, mV, V, Pyrometer (Thermocouple), DVU
- AC: mA, A, V, VU Frequency
- Custom designed inputs and scales available

### Performance

<b>Accuracy*</b>	$\pm 2\%$ DC; $\pm 2\%$ AC - iron vane; $\pm 3\%$ AC - rectifier type (60Hz sine wave)
<b>Tracking*</b>	$\pm 1 \frac{1}{2}\%$ DC; $\pm 2\%$ AC; vertical mounting
<b>Repeatability*</b>	0.5% DC and rectifier; $\pm 2\%$ iron vane
<b>Response Time</b>	1.5 seconds maximum for all ranges, except 0-50 $\mu\text{A}$ and below, where the response time is 3.0 seconds maximum.
<b>Symmetry*</b>	$\pm 1.5\%$
<b>Resistance</b>	$\pm 10\%$ DC and rectifier; $\pm 30\%$ iron vane
<b>Scale Arc</b>	100° (iron vane 90°)
<b>Shielding</b>	Self-shielded; no special calibration needed for steel or non-ferrous panel mounting, including iron vane meters.

Meter Size	DC & Rectifier	Iron Vane
Scale Length - 1 ½"	1.75"	----
Scale Length - 2 ½"	2.41"	2.15"
Scale Length - 3 ½"	3.00"	2.70"
Scale Length - 4 ½"	4.22"	3.80"
Scale Length - 5 ½"	5.12"	----

\*Percent of full scale. On zero center meters, specification applies to full scale, not end scale values, e.g., 50-0-50  $\mu\text{A}$  is 100  $\mu\text{A}$  full scale.

## Outline Drawing - S Series

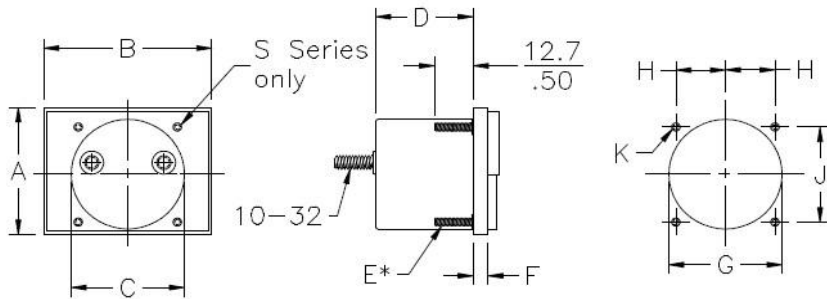

S Series panel cutout

## Dimensional Data - S Series

		A	B	C	D	E*	F	G	H	J	K
1S	mm.	44.5	56.9	38.36	33.0	M3*	3.5	39.4	16.7	33.3	3.2
	in.	1.75	2.24	1.51	1.30	4-40	.136	1.55	.656	1.31	.125
2S	mm.	58.2	76.58	54.1	33.0	M3*	4.06	56.4	23.9	47.8	3.2
	in.	2.29	3.015	2.13	1.30	4-40	.160	2.22	.940	1.88	.125
3S	mm.	73.7	94.7	67.31	33.0	M3*	4.32	71.6	28.4	57.2	3.2
	in.	2.90	3.73	2.65	1.30	4-40	.170	2.82	1.125	2.25	.125
4S	mm.	100.6	129.5	67.31	33.0	M3.5*	5.33	71.6	50.8	90.4	3.8
	in.	3.96	5.10	2.65	1.30	6-32	.210	2.82	2.00	3.56	.150
5S	mm.	113.8	148.6	67.31	33.0	M3.5*	5.59	71.6	66.8	76.2	3.8
	in.	4.48	5.85	2.65	1.30	6-32	.220	2.82	2.63	3.00	.150
5S Opt.1	mm.	113.8	148.6	67.31	33.0	M3.5*	5.59	71.6	57.2	88.9	3.8
	in.	4.48	5.85	2.65	1.30	6.32	.220	2.82	2.25	3.50	.150

## Available Options

## How to Order

Suffix	Option	S
A	Improved Accuracy <sup>1</sup>	●
-	Bezel Mount Kits ("BA")	●
B	4-stud Mounting	*
C	Colors, Meter Cover & Bezel	●
D	Blank Dials	●
DD	Opaque Dials	*
E	Custom Resistance <sup>1 2</sup>	●
F	Fast Response <sup>1 2</sup>	●
G	Custom Pointers	●
IEC	ANSI Symbols on Dial	●
KW	Illumination	●
M	Mirror Scale	●
NL	Heavy Damping <sup>3</sup>	●
NS	Untacked Covers	●
P	Single Point Calibration	●
R	Improved Resistance	●
S	Sealed Case	●
T	Temperature Compensation <sup>1</sup>	●
U	Unit Meter Packaging	●
V	High Resistance Voltmeters <sup>1</sup>	●
X2	Metric Studs & Terminals	●
Y	Insulated Terminals	●
Z	Rear Zero Adjust <sup>1</sup>	●

Please refer to the Series S & W Catalog. When placing an order, replace the □ in the catalog number with an "S". Mention any options you would like to add to your meter.

## Panel Meter Sales Contact Information

Toll Free 800-638-3771

meters@jewellinstruments.com

Notes: <sup>1</sup> Not available on AC types. <sup>2</sup> Extra time required for set up. <sup>3</sup> Not available on iron-vane types. \* Furnished as standard. ● Option Available

[www.jewellinstruments.com](http://www.jewellinstruments.com)