

REVISIONS				
REV.	DESCRIPTION	ECO #	DATE	ENGINEER
A	RELEASE	29050	12/13/2018	TAD
B	REMOVED 00358-01M, REMOVED CABLE COLORS	30543	6/10/2022	JES

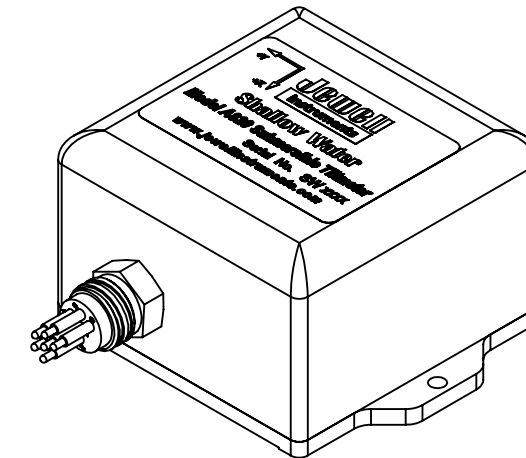

NOTES:

- UNITS: $\frac{[mm]}{IN}$
- CONNECTOR PART NUMBER: SUBCONN MCBH6M. MATES WITH SUBCONN MCIL6F.

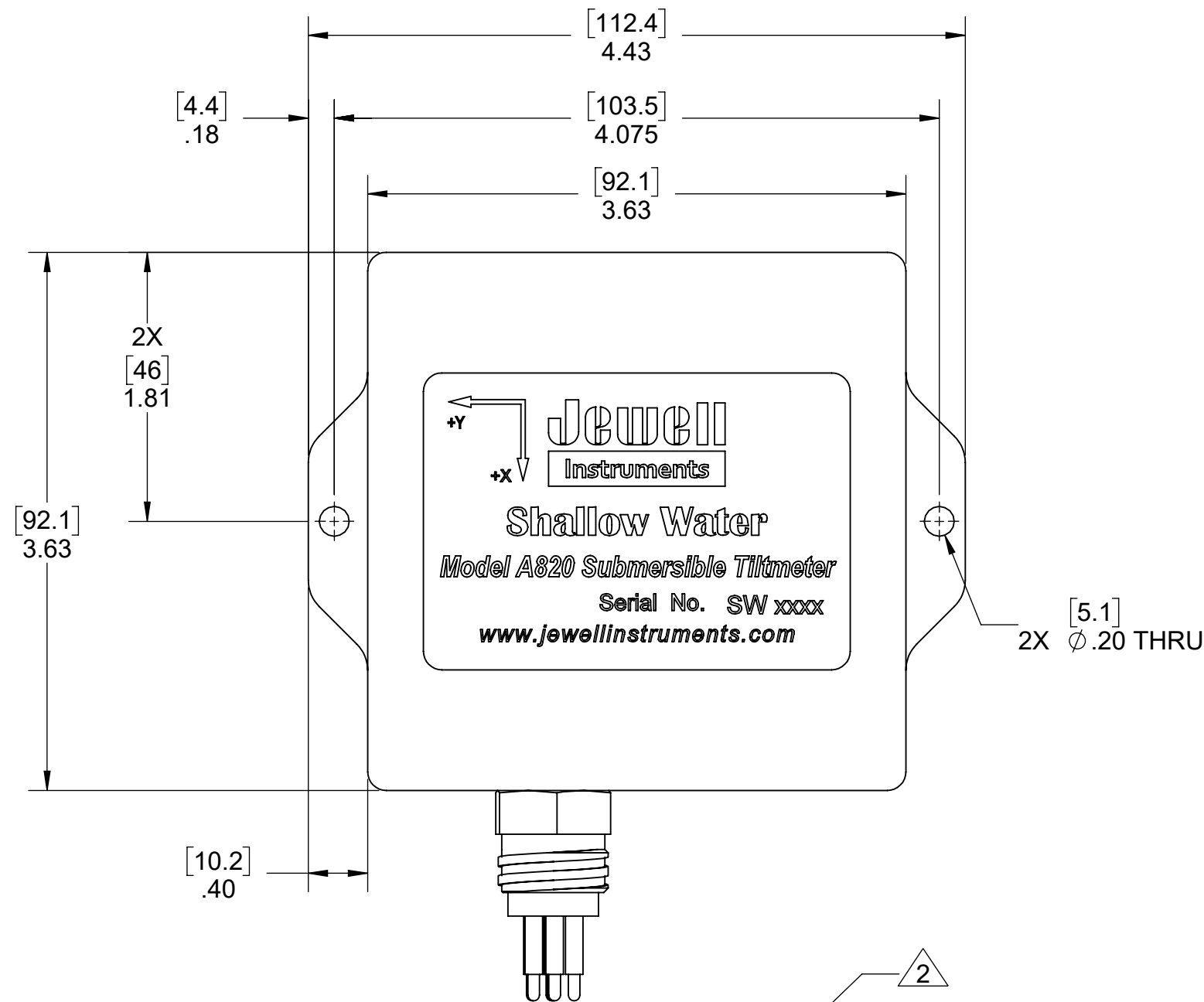
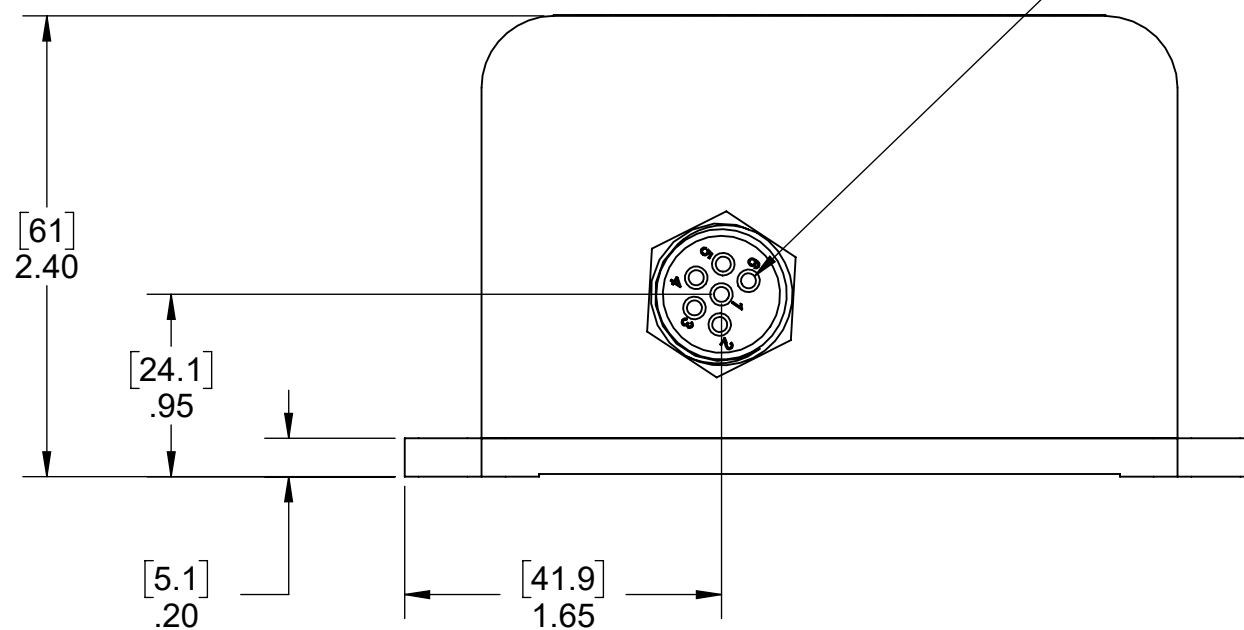

CONNECTOR PINOUT

PIN	ASSIGNMENT
1	PWR GND
2	SIGNAL GND
3	PWR
4	X-TILT
5	TEMP
6	Y-TILT

MATERIAL	DIMENSIONS UNITS ARE: [mm] INCH	<p>Jewell Instruments MANCHESTER, NH TRIPLETT MODUTEC A&M EMICO</p>	TITLE A820-SW BIAXIAL A820 OUTLINE DRAWING	
FINISH	TOLERANCE UNLESS SPECIFIED TWO PLACE DECIMALS .00 ± .01 THREE PLACE DECIMALS .000 ± .005 ANGLES ± 1°		DRAWING NO. OD98823	REV. B
CHECKED BY GN	DATE 1/22/2020	DRAWN BY TAD	DATE 6/23/2015	SCALE 1:1
APPROVED BY RB	DATE 1/16/2020	<p><small>PROPRIETARY NOTICE</small> THIS DRAWING IS THE PROPERTY OF JEWELL INSTRUMENTS, LLC. NEITHER THIS DOCUMENT NOR THE DATA CONTAINED HEREIN SHALL BE DISCLOSED, REPRODUCED IN WHOLE OR IN PART WITHOUT THE WRITTEN AUTHORIZATION OF JEWELL INSTRUMENTS, LLC. NO RIGHT IS GRANTED TO DISCLOSE OR SO USE ANY INFORMATION CONTAINED HEREIN. ALL RIGHTS RESERVED.</p>		CAGE CODE 33005
				SHEET 1 OF 3

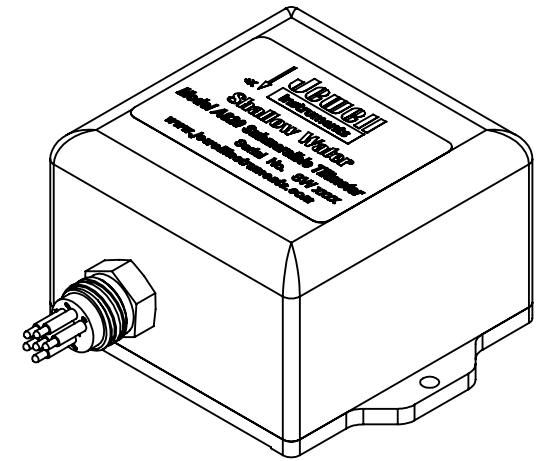
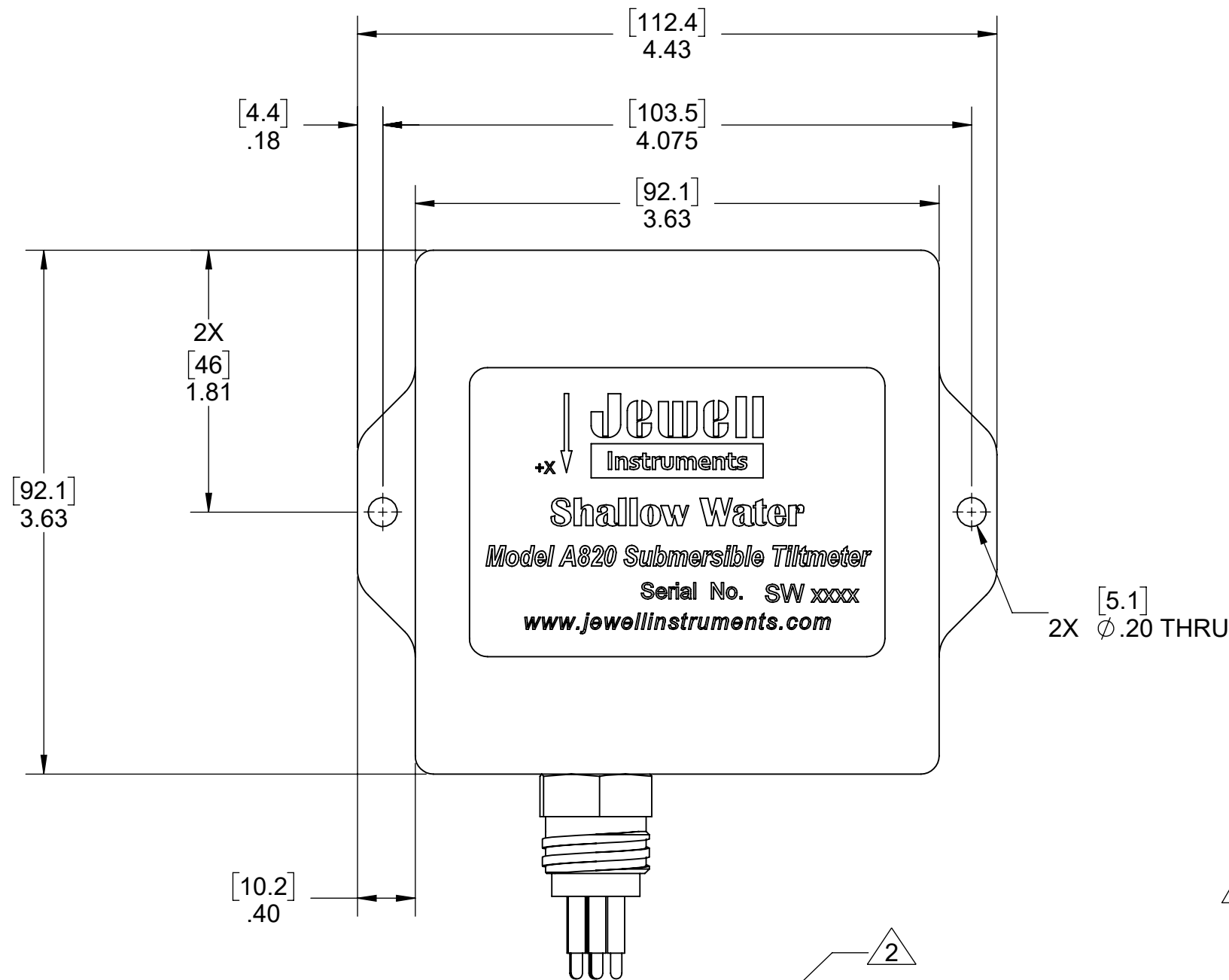

NOTES:

1. UNITS: $\frac{[mm]}{IN}$

2. CONNECTOR PART NUMBER: SUBCONN MCBH6M. MATES WITH SUBCONN MCIL6F.

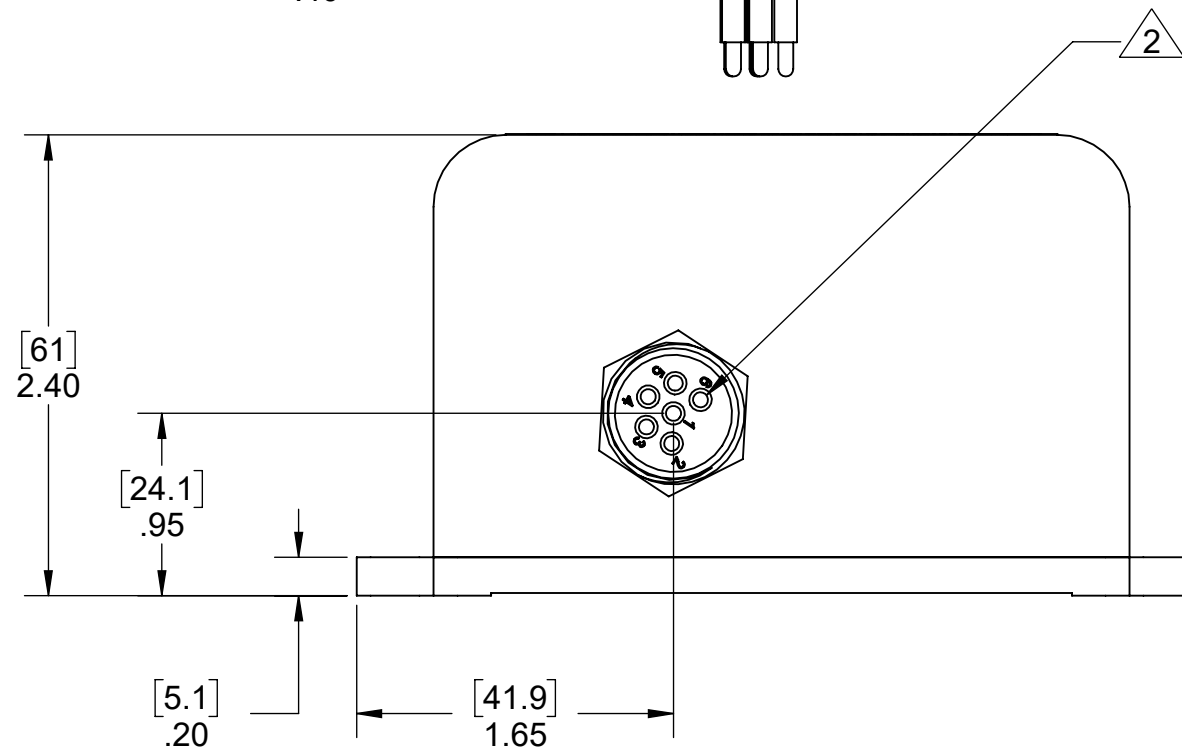

CONNECTOR PINOUT

PIN	ASSIGNMENT
1	PWR GND
2	SIGNAL GND
3	PWR
4	X-TILT
5	TEMP
6	N/C

MATERIAL	DIMENSIONS UNITS ARE: [mm] INCH	<p>MANCHESTER, NH TRIPLETT MODUTEC A&M EMICO</p>	TITLE	A820-SW TRANSVERSE A820 OUTLINE DRAWING	
FINISH	TOLERANCE UNLESS SPECIFIED TWO PLACE DECIMALS .00 ± .01 THREE PLACE DECIMALS .000 ± .005 ANGLES ± 1°		DRAWING NO.	OD98823	
CHECKED BY	DATE	DRAWN BY TAD	DATE 6/23/2015	SCALE	1:1
APPROVED BY	DATE			CAGE CODE	33005
<p>PROPRIETARY NOTICE THIS DRAWING IS THE PROPERTY OF JEWELL INSTRUMENTS, LLC. NEITHER THIS DOCUMENT NOR THE DATA CONTAINED HEREIN SHALL BE DISCLOSED, REPRODUCED IN WHOLE OR IN PART WITHOUT THE WRITTEN AUTHORIZATION OF JEWELL INSTRUMENTS, LLC. NO RIGHT IS GRANTED TO DISCLOSE OR SO USE ANY INFORMATION CONTAINED HEREIN. ALL RIGHTS RESERVED.</p>			SHEET 2 OF 3		

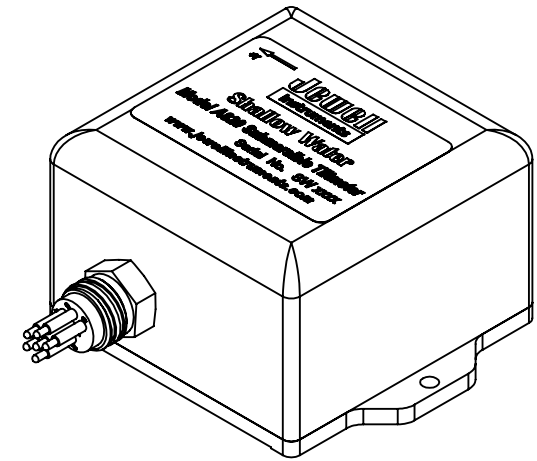
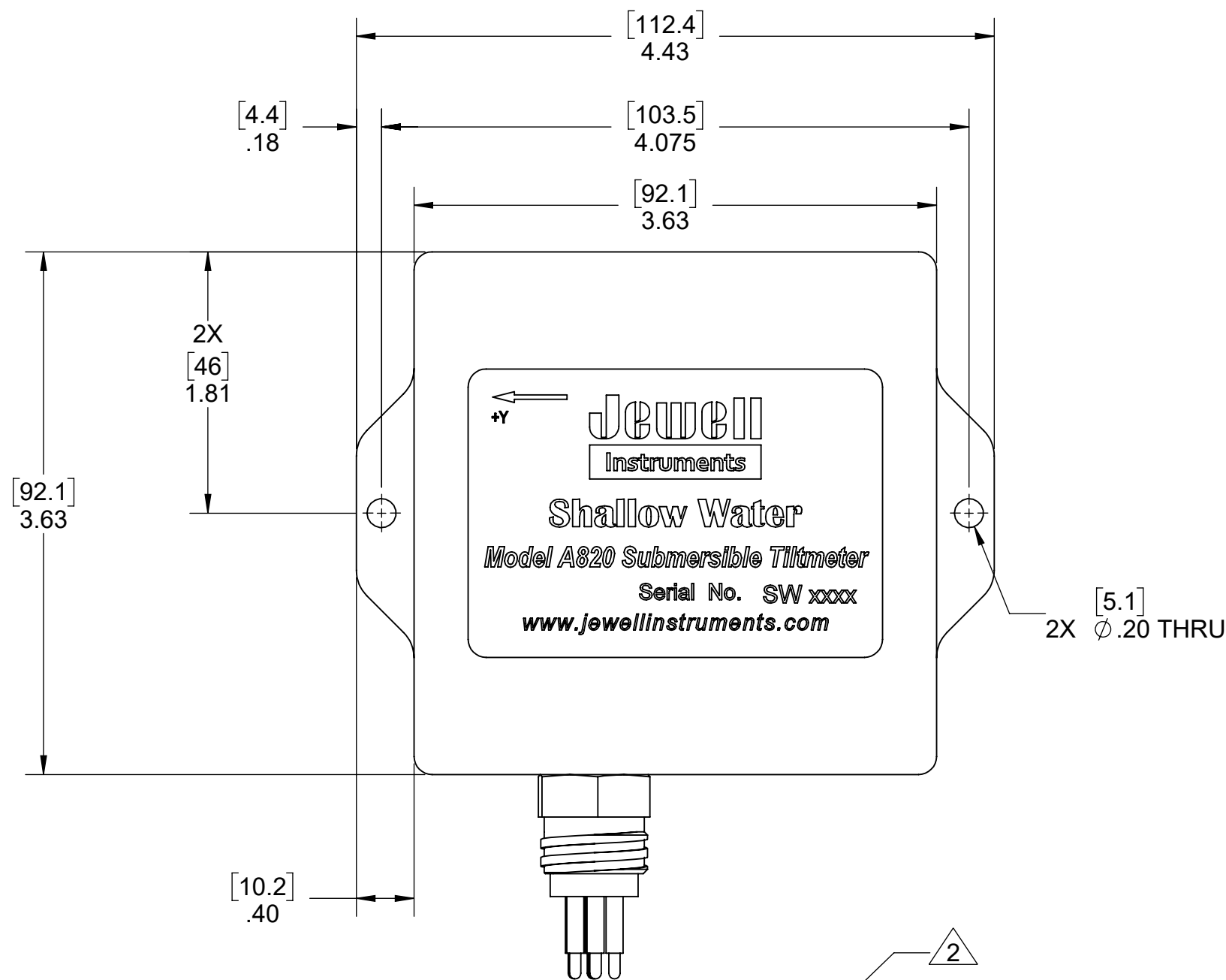

NOTES:

1. UNITS: $\frac{[mm]}{IN}$

2. CONNECTOR PART NUMBER: SUBCONN MCBH6M. MATES WITH SUBCONN MCIL6F.

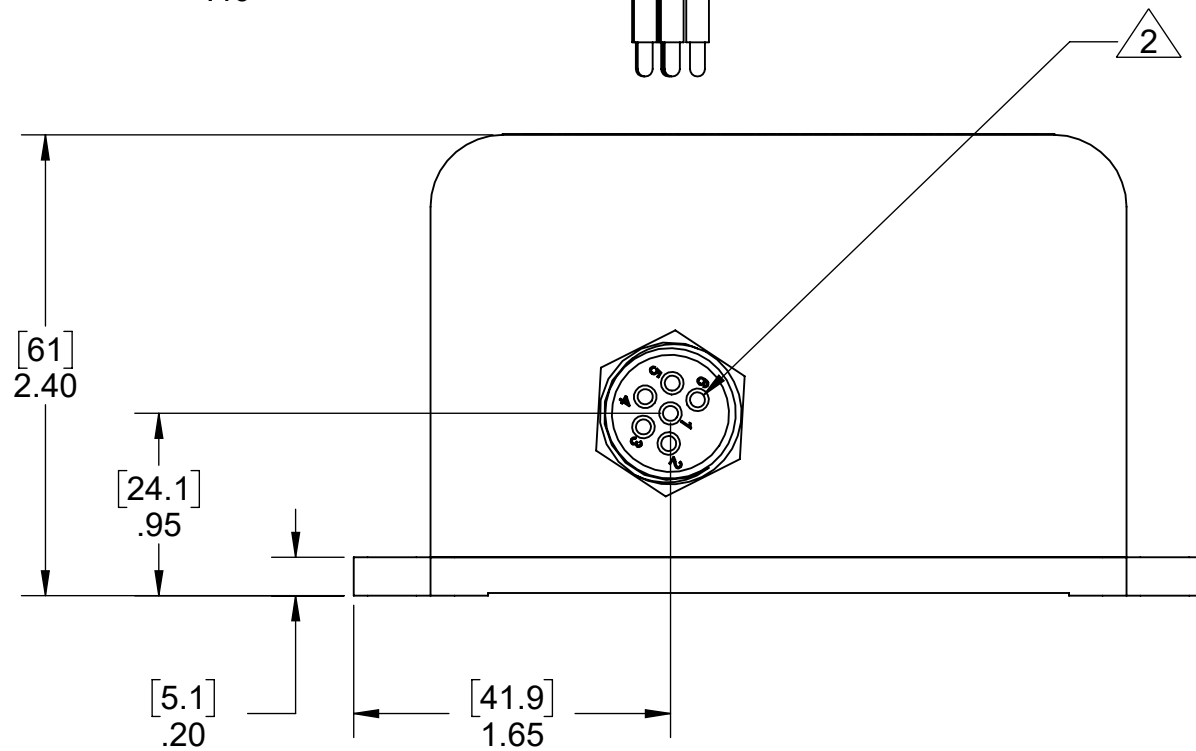

CONNECTOR PINOUT

PIN	ASSIGNMENT
1	PWR GND
2	SIGNAL GND
3	PWR
4	N/C
5	TEMP
6	Y-TILT

MATERIAL	DIMENSIONS UNITS ARE: [mm] INCH	<p>Jewell Instruments MANCHESTER, NH TRIPLETT MODUTEC A&M EMICO</p>	TITLE A820-SW LONGITUDINAL A820 OUTLINE DRAWING	
	FINISH		TOLERANCE UNLESS SPECIFIED TWO PLACE DECIMALS .00 ± .01 THREE PLACE DECIMALS .000 ± .005 ANGLES ± 1°	DRAWING NO. OD98823
CHECKED BY	DATE	DRAWN BY TAD	DATE 6/23/2015	
APPROVED BY	DATE	<p>PROPRIETARY NOTICE THIS DRAWING IS THE PROPERTY OF JEWELL INSTRUMENTS, LLC. NEITHER THIS DOCUMENT NOR THE DATA CONTAINED HEREIN SHALL BE DISCLOSED, REPRODUCED IN WHOLE OR IN PART WITHOUT THE WRITTEN AUTHORIZATION OF JEWELL INSTRUMENTS, LLC. NO RIGHT IS GRANTED TO DISCLOSE OR SO USE ANY INFORMATION CONTAINED HEREIN. ALL RIGHTS RESERVED.</p>		SCALE 1:1
				CAGE CODE 33005
				SHEET 3 OF 3