

REVISIONS				
REV	DESCRIPTION	DATE	ECO	DRFTSMN
1	INITIAL DESIGN	12-13-21		TAD

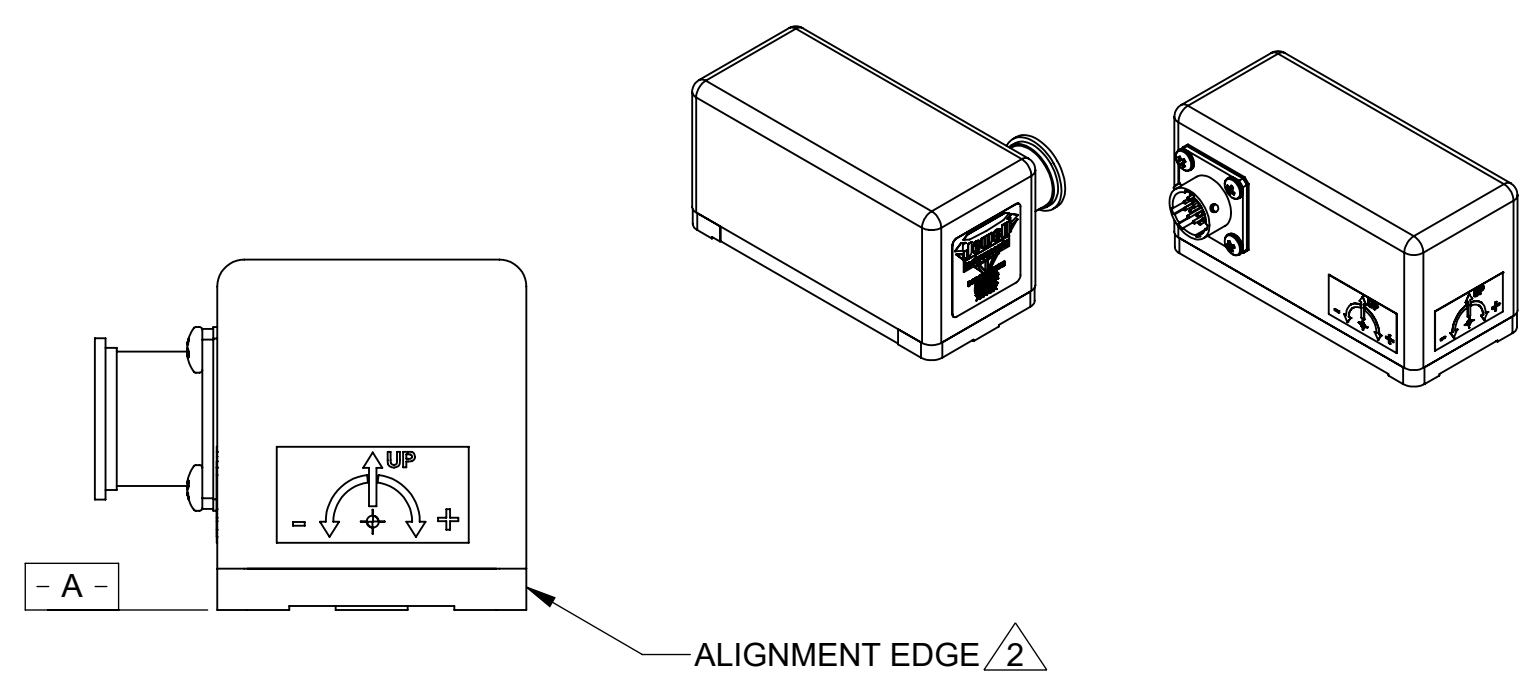

MOUNTING:  
STANDARD: 3X #6-32  
METRIC: 3X M3X0.5  
[8.4]  
↓  
.33 MAX

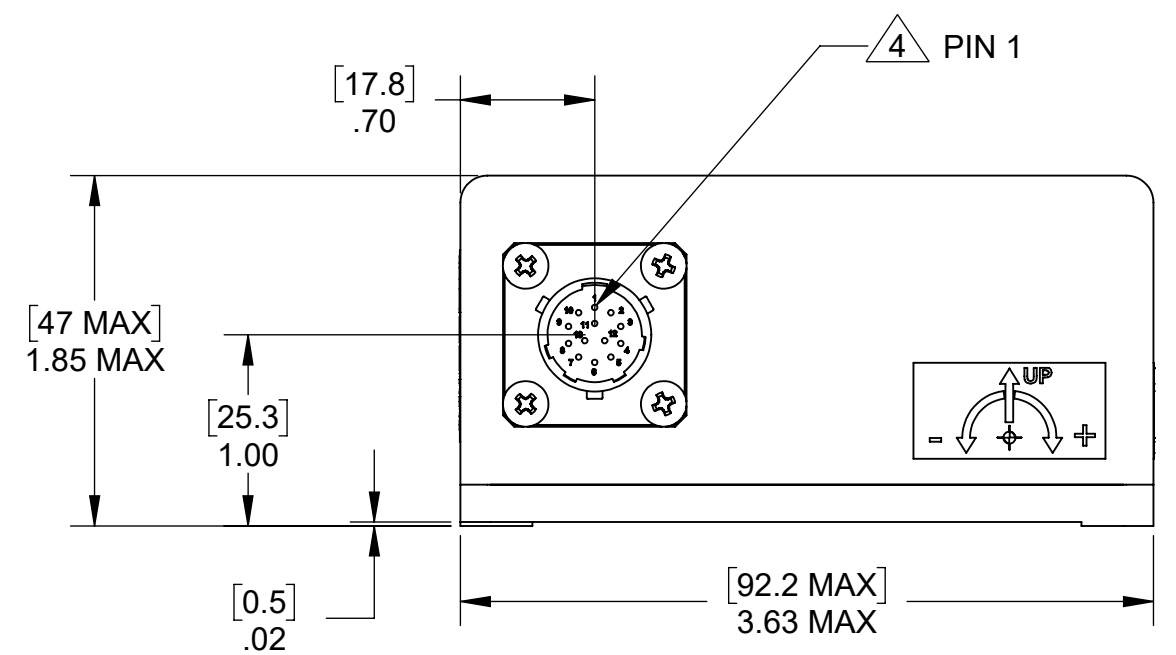
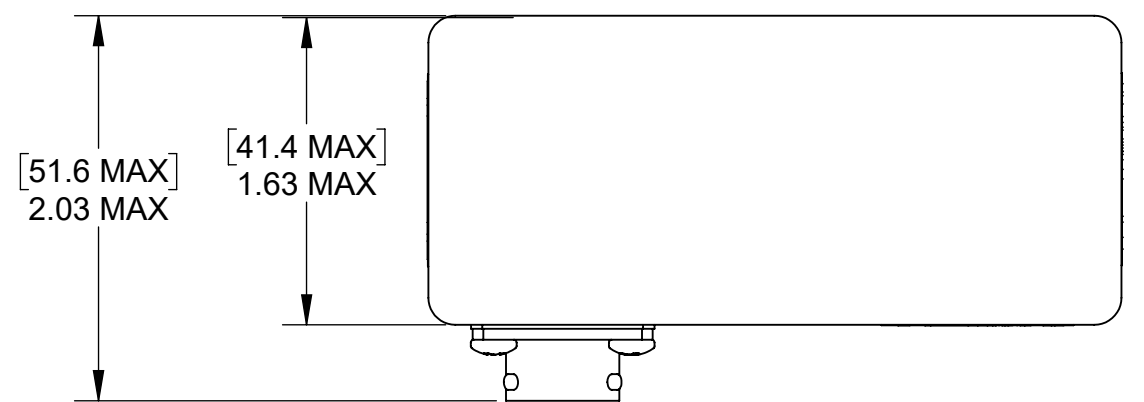
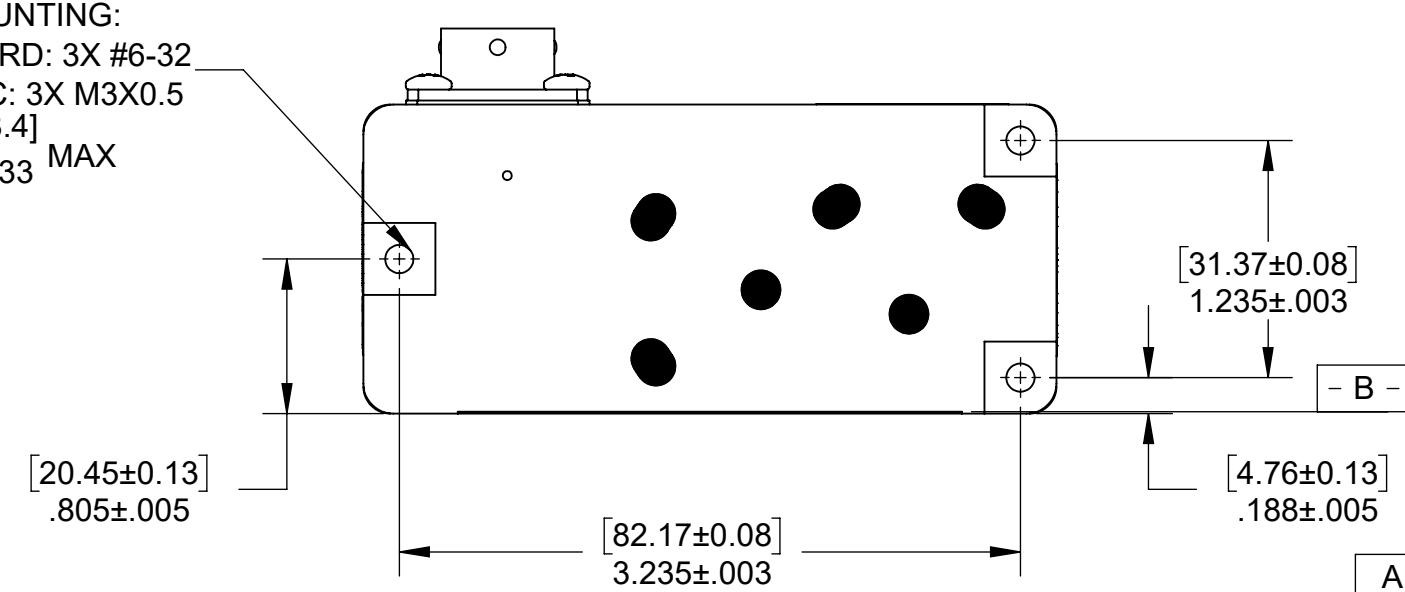

NOTES:

1. UNITS: [mm]  
in
2. ALIGNMENT EDGE SHOULD BE NO HIGHER THAN .19 [4.8] TO AVOID INTERFERENCE WITH COVER.
3. -A- & -B- ARE DEFINED AS REFERENCE SURFACES.
4. CONNECTOR: MS27476Y10D35P  
MATES WITH: MS27473T10B35S

CONN. PIN	FUNCTION
1	FACTORY USE
2	FACTORY USE
3	CASE GROUND
4	+SERIAL PORT
5	-SERIAL PORT
6	FACTORY USE
7	FACTORY USE
8	FACTORY USE
9	FACTORY USE
10	FACTORY USE
11	PWR RTN
12	+PWR
13	FACTORY USE

APPLICATION		DIMENSIONS ARE IN INCHES AND APPLY TO PART BEFORE FINISHING
USED ON	NEXT ASSY	TOLERANCE UNLESS SPECIFIED
		TWO PLACE DECIMALS (.00) ± .01
		THREE PLACE DECIMALS (.000) ± .005
		ANGLES ± 1°
		RAW MATL - COMMERCIAL STANDARD
MATERIAL	DRAWN	DATE
	TAD	12/13/2021
	CHECKER	DATE
FINISH	APPROVED	DATE

**Jewell Instruments**  
MANCHESTER, NH  
TRIPLETT MODUTEC A&M EMICO

PROPRIETARY NOTICE  
THIS DRAWING IS THE PROPERTY OF JEWELL INSTRUMENTS, LLC. NEITHER THIS DOCUMENT NOR THE DATA CONTAINED HEREIN SHALL BE DISCLOSED, REPRODUCED IN WHOLE OR IN PART WITHOUT THE WRITTEN AUTHORIZATION OF JEWELL INSTRUMENTS, LLC. NO RIGHT IS GRANTED TO DISCLOSE OR SO USE ANY INFORMATION CONTAINED HEREIN. ALL RIGHTS RESERVED.

TITLE		
D750 SERIES OUTLINE DRAWING		
DRAWING NO.	REV	
OD98750-D	1	
SCALE	CAGE CODE	SHEET 1 OF 1
1:1	33005	