

REVISIONS				
REV.	DESCRIPTION	ECO #	DATE	ENGINEER
A	RELEASE TO PRODUCTION	29370	8/12/2019	GN

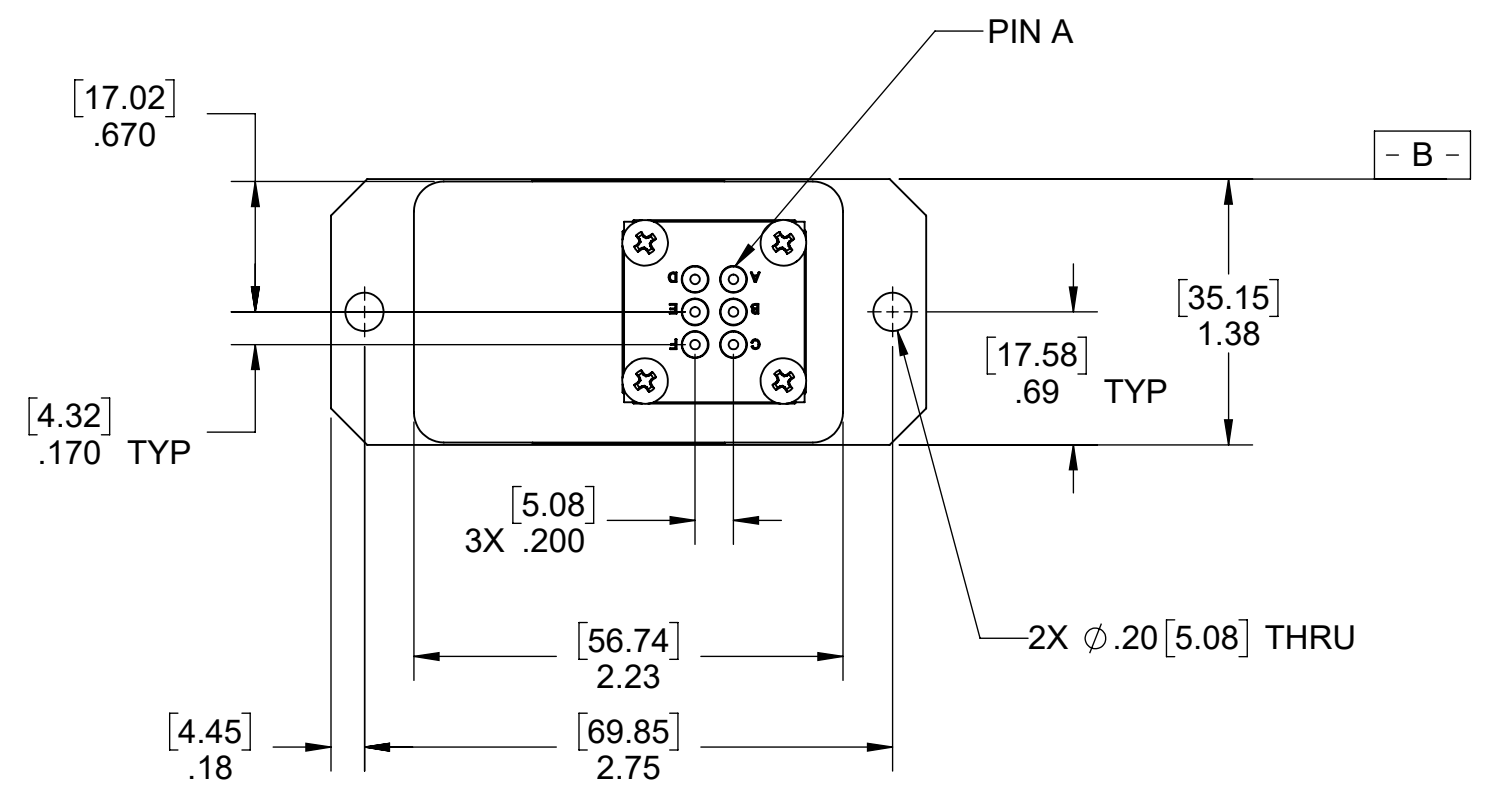

PIN	FUNCTION	
	DUAL SUPPLY	SINGLE SUPPLY OR 4-20mA OUTPUT
A	+ VDC	+ VDC
B	PWR / SIG COM	PWR / SIG COM
C	- VDC	N/C
D	SIG OUT	SIG OUT
E	N/C	N/C
F	N/C	N/C

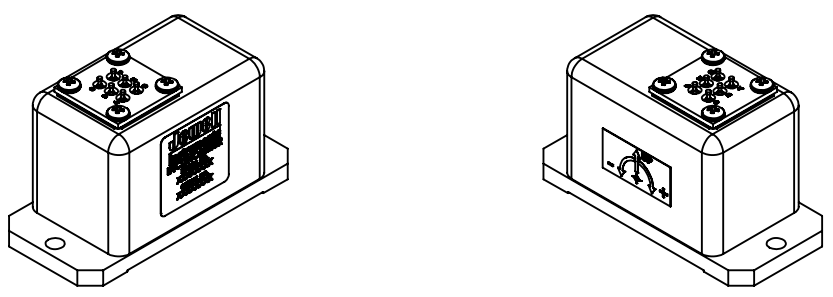
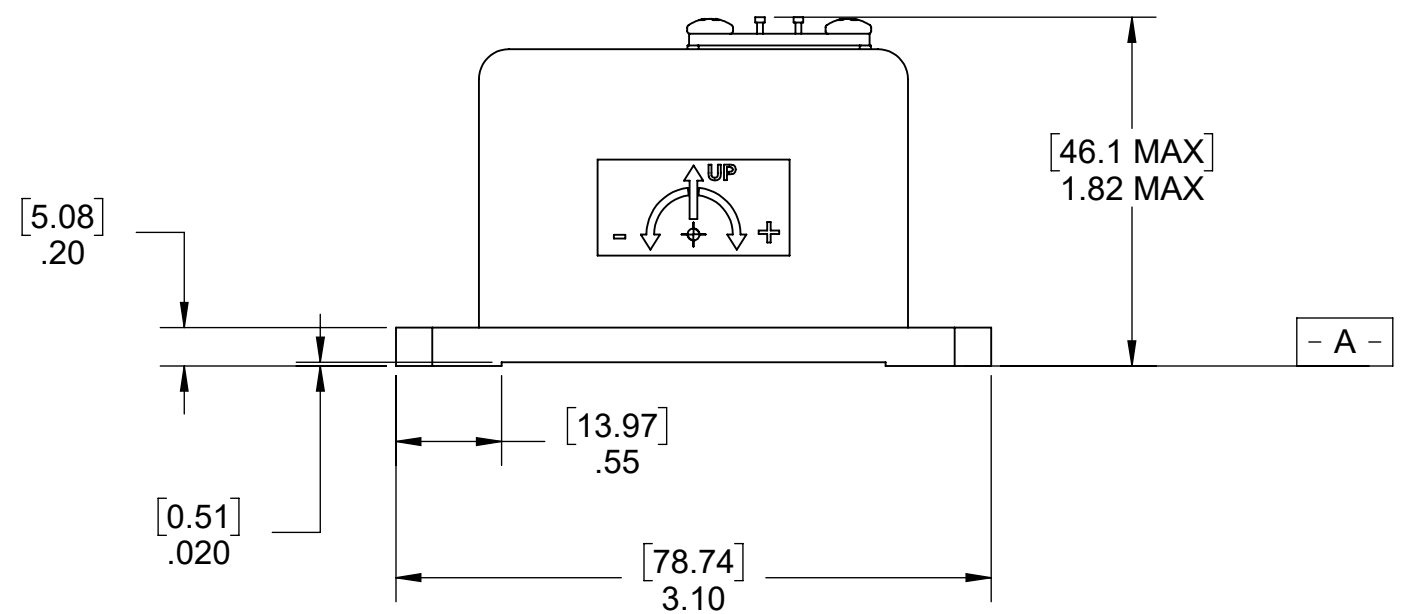

NOTES:  
 1. - A - AND - B - ARE DEFINED REFERENCE SURFACES.

MATERIAL	DIMENSIONS UNITS ARE: [mm] INCH	 <b>Jewell Instruments</b> MANCHESTER, NH TRIPLETT MODUTEC A&M EMICO	TITLE	
	FINISH		LCF-300-P OUTLINE DRAWING	
CHECKED BY	DATE	TOLERANCE UNLESS SPECIFIED TWO PLACE DECIMALS .00 ± .01 THREE PLACE DECIMALS .000 ± .005 ANGLES ± 1°	DRAWING NO.	REV.
MAF	12/11/2019	DRAWN BY	OD02550361-000	A
APPROVED BY	DATE	GN	8/19/2019	
TAD	12/11/2019		SCALE	CAGE CODE
			DO NOT SCALE	33005
<small>PROPRIETARY NOTICE</small> THIS DRAWING IS THE PROPERTY OF JEWELL INSTRUMENTS, LLC. NEITHER THIS DOCUMENT NOR THE DATA CONTAINED HEREIN SHALL BE DISCLOSED, REPRODUCED IN WHOLE OR IN PART WITHOUT THE WRITTEN AUTHORIZATION OF JEWELL INSTRUMENTS, LLC. NO RIGHT IS GRANTED TO DISCLOSE OR SO USE ANY INFORMATION CONTAINED HEREIN. ALL RIGHTS RESERVED.			SHEET 1 OF 1	