

Model C802

DeepWater Analog Tiltmeter

The model C802 Deepwater is a high-precision submersible tiltmeter for use in marine, offshore, and deep ocean applications with 4-20mA output. Using an absolute gravity referenced electrolytic sensor, the C802 delivers superior measurement accuracy with virtually no long-term drift. High-gain units are sensitive to <0.0017 mm/m or better. All units are rated to +2500m waterproof for advanced protection from the elements. Use the D802 "DeepWater" for structural monitoring, angle measurement and control, platform leveling, and more.

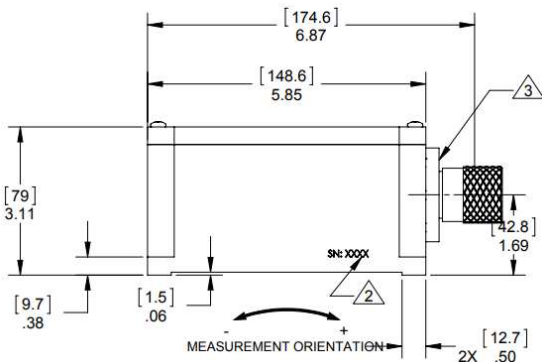
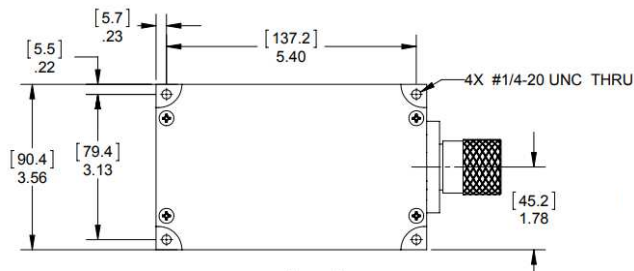

Dimensions: in [mm]

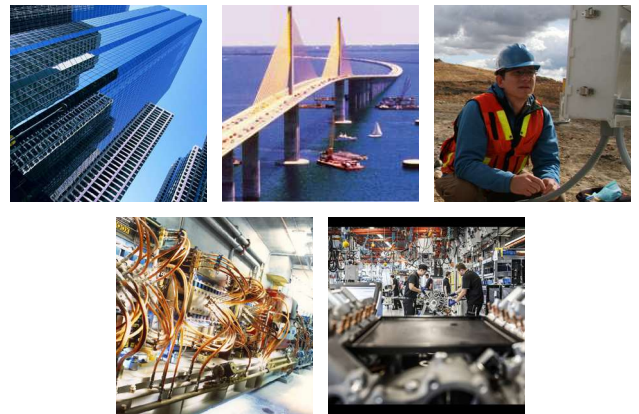

APPLICATIONS:

- Structural Monitoring
- Platform Leveling
- Industrial Measurement & Control

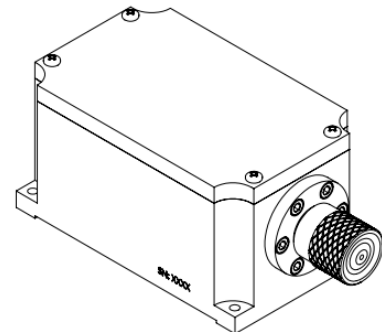

PERFORMANCE SPECIFICATIONS

PERFORMANCE

ANGULAR RANGE (°) ¹	±0.5°	±3°	±50°
RESOLUTION	<0.0001°	0.0006°	0.01°
NONREPEATABILITY (° max)	<0.0002°	0.001°	0.02°
NONLINEARITY (%FRO) ² max	±1	±2	±0.5
SCALE FACTOR	0.0625°/mA	0.375°/mA	6.25°/mA
TIME CONSTANT	0.15 sec		
Kz TEMP COEFFICIENT (°/°C)	±0.0002 °/°C (typical)		±0.002 °/°C (typical)
Ks TEMP COEFFICIENT (%/°C)	<0.04%/°C (typical)		<0.1%/°C (typical)
OUTPUT	4-20mA Two-wire current loop (per axis)		
CHANNELS	Tilt, Temperature		

ELECTRICAL & ENVIRONMENTAL

NUMBER OF AXES	1 or 2
OUTPUT IMPEDANCE (Ohms, nominal)	270
TEMPERATURE OUTPUT	0.1°C/mV typical (single ended; 0°C = 0mV)
POWER	(0.02 Ampere x R + 10 VDC) < Vs < 29 VDC
OPERATING TEMPERATURE RANGE	-4° to +60°C
STORAGE TEMPERATURE RANGE	-40° to +85°C
WEIGHT	5 kg (11 lb.)
MATERIALS	316 SS (6AL-4V Titanium also available)
SEAL	IP68
CABLE	6-conductors, Neoprene, 20 AWG, no shield

PIN OUT:

WIRE COLOR	FUNCTION
BLACK	PWR GND
WHITE	SIG GND
RED	V+
GREEN	+TILT
YELLOW	TEMP
BLUE	-TILT

NOTES:

1. Custom ranges available on request
2. Nonlinearity is specified as deviation of output referenced to theoretical sine function value, independent of misalignment

Specifications are subject to change without notice due to continued product development



ORDERING INFORMATION

HOW TO ORDER Model Numbers are comprised of the series, the number of axes, and the angular range.

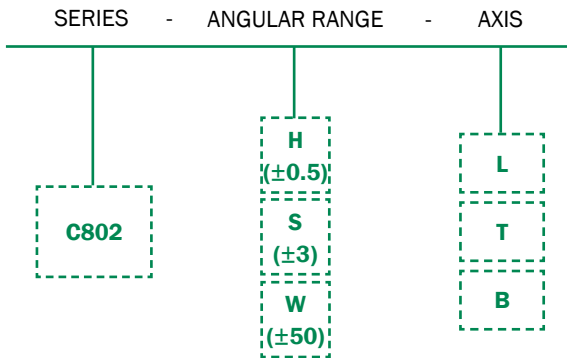

	MODEL #	PART #
±0.5	C802-HL	98043-08-ROHS
	C802-HT	98043-07-ROHS
	C802-HB	98043-09-ROHS
±3	C802-SL	98043-03-ROHS
	C802-ST	98043-01-ROHS
	C802-SB	98043-05-RO HS
±50	C802-WL	98043-04-ROHS
	C802-WT	98043-02-ROHS
	C802-W13	98043-06-ROHS

Accessories:

PART #	DESCRIPTION
00389	Extra 8-socket Female in-line connector, Neoprene, on 24-inch (60 cm) Cable Whip (bare wire leads)
00359	Extra Delrin Locking Sleeve (locks 00358 and 00389 in-line connector to Male bulkhead)
00358-xxx	Extra 6-socket Female in-line connector, Neoprene, (bare wire leads) price per foot